



Designed and Made  
in Australia

[www.the2terrys.com](http://www.the2terrys.com)

Users of this attachment do so at their own risk. The manufacturers and suppliers will not take responsibility for personal injury or property damage resulting from inappropriate use, or incorrect use of this attachment. Tampering with this attachment, or modifying this attachment voids all claims on the supplier and manufacturer.

Super Snipper® will fit most commonly available petrol powered line trimmers - & some electric trimmers. If you can not utilize the existing attachment fittings on your equipment, a variety of alternative fasteners and spacer pieces is provided with your Super Snipper® to ensure a successful assembly. You may also need to visit a mower/trimmer shop for assistance if your equipment is not accommodated by the supplied fasteners.

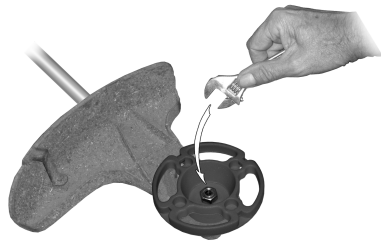

### Straight Shaft Trimmer

1. Remove the existing head from your line trimmer.
2. Fit *Super Snipper* in place with the hollow section facing out. One of the supplied plastic spacers may be required first before positioning *Super Snipper*.
3. If you can not use the nut or bolt from your old trimmer head select a nut (or bolt) from the supplied adapter pack to suit your threaded shaft (or hole).
4. Engage as much of the thread as possible - a spanner may be useful here.
5. Rotate *Super Snipper* by hand, using *Super Snipper* as a spanner, in the direction

needed to tighten. Do not over-tighten - the unit is self tightening.

### Bent Shaft Trimmer

1. Remove the existing head or line spool from your line trimmer.
2. On some models the old spool outer housing cannot be removed - position the supplied spacer cup into the cavity first, then fit *Super Snipper* on with the hollow section facing out.
3. If you can not use the nut or bolt from your old trimmer head select a nut (or bolt) from the supplied adapter pack to suit the threaded shaft (or hole).
4. Engage as much of the thread as possible - a spanner may be useful here.
6. Rotate *Super Snipper* by hand, using *Super Snipper* as a spanner, in the direction

### NOTE

When the old head is removed from some line trimmers you will be presented with a long, bare spindle with a threaded end (or a threaded hole in the end).

This space needs to be filled with a packer.

This packer can be either:

- ◆ a piece of steel tube cut to length, or,
- ◆ a stack of nuts or similar handy spacers.

Make the length of the packers and washer so that the securing nut (or bolt) clamps the Super Snipper head firmly onto the spindle.

**Ensure the spindle spins freely before starting your line trimmer.**

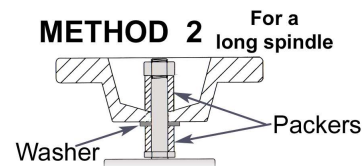
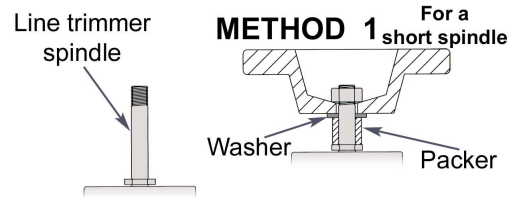

Replacing lines is quick and easy.

### STEP 1

A bend on the end of the line makes loading easier. Insert the end of the line into one of the holes and make a bend in the end of the line, as shown below.

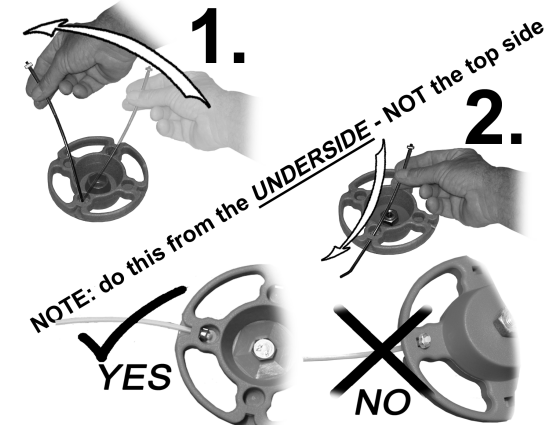

### STEP 2

Thread the line through until the clinched end snaps into place into the circular recess.

To remove - first bend the worn end upwards, and then push the clinched end out.

[www.the2terrys.com](http://www.the2terrys.com)

- See other great innovative products -

### Warranty

This product is covered by warranty providing the nature of the claim is the result of faulty workmanship. Misuse or abuse voids all warranty. Warranty claims must be reported to the Selling Agent from whom it was originally purchased. The warranty is valid for a period of ninety days starting from the purchase date. The warranty will be void if any unauthorised persons tamper with the product or parts.